

Acoustic Treatment for your Home

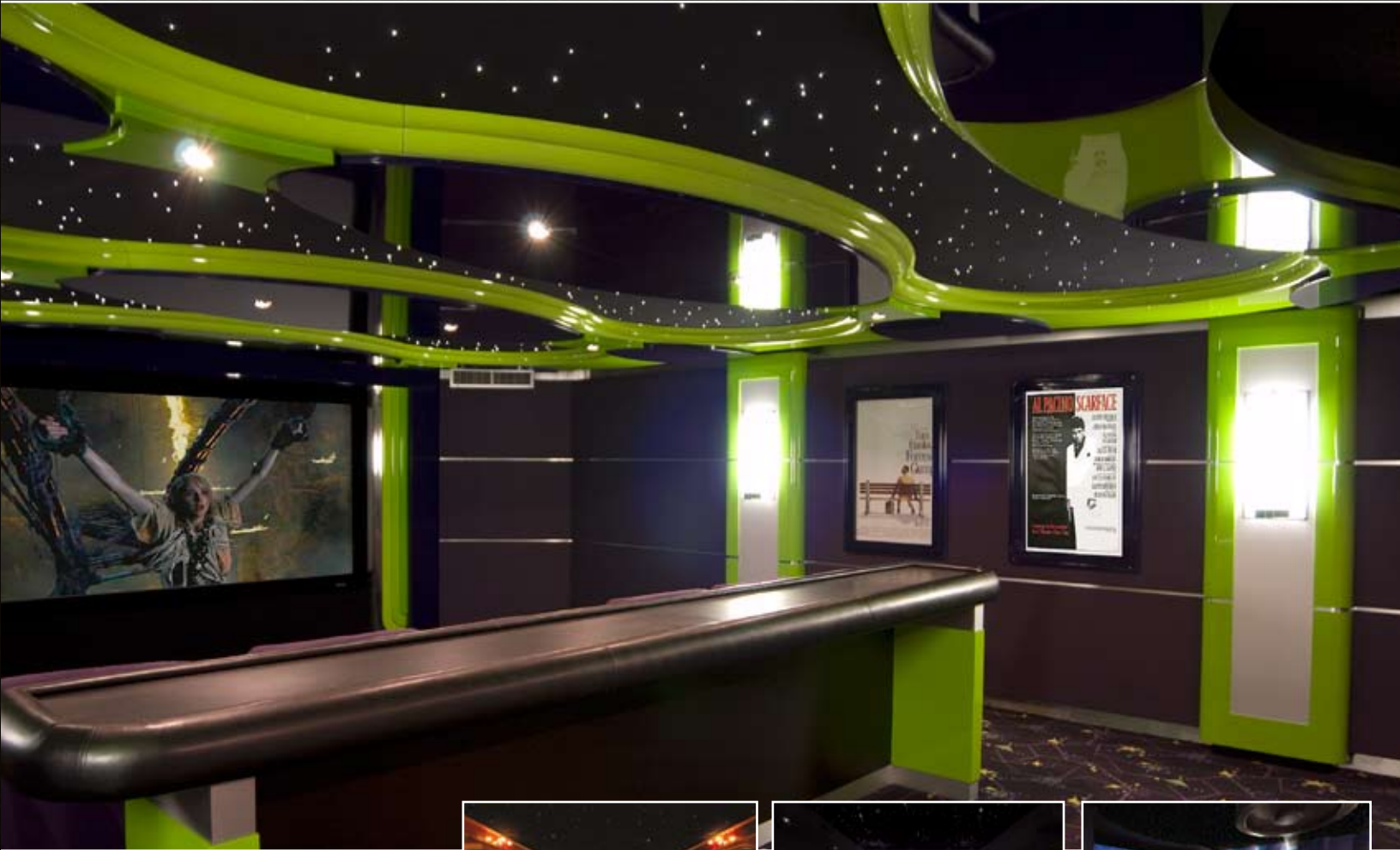

 **Auralex**<sup>®</sup>  
acoustics

# About Auralex

Are you hearing your audio system, or are you hearing your room? The answer is both. Is the room contributing in a good way or a bad way? Does your room compliment your audio system, or does it degrade the sound? Are you getting the most out of your audio investment?

Auralex Acoustics specializes in your listening environment. We personally engineer each listening room, home theater, and audio space for maximum accuracy and entertainment so you always have the best seat in the house!

## Table of Contents

How Does Sound Work? . . . . .	4
Sound Isolation . . . . .	5
ELiTE™ Custom Fabric System (ELiTE™ -CFS) . . . . .	6-7
Custom Installation Options. . . . .	8
ELiTE™ ProPanels . . . . .	9
SonoSuede™ Systems . . . . .	10
SonicPrint™ Acoustical Panels . . . . .	11



# How Does Sound Work?

What we hear is always a combination of the direct sound source and the reflected sound from the room. Reflected sound waves travel a longer distance and arrive to our ears later than direct sounds, distorting or muddling our perception of the direct sound and making it more difficult to understand. As a result, we turn up the volume and make matters worse.

Auralex has the tools and the expertise to help you control this reflected energy in a way that optimizes the acoustical architecture of your room, without sacrificing aesthetics.

We offer three levels of acoustical analysis services to help you find the best treatment for your room no matter what your budget! Start by giving us a detailed description and sketch of your room with the Personalized Room Analysis Form. This popular service accounts for most of the variances that affect sound in your room. Need more help? The Room Analysis Plus Kit and Pro Service add more hands-on help and advice from the experts at Auralex, and can be purchased through your dealer.

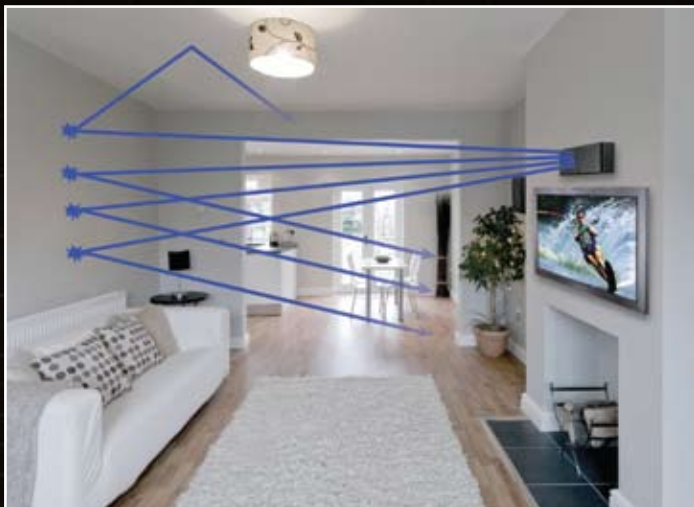

Sound travel without Auralex



Sound travel with Auralex

# Sound Isolation

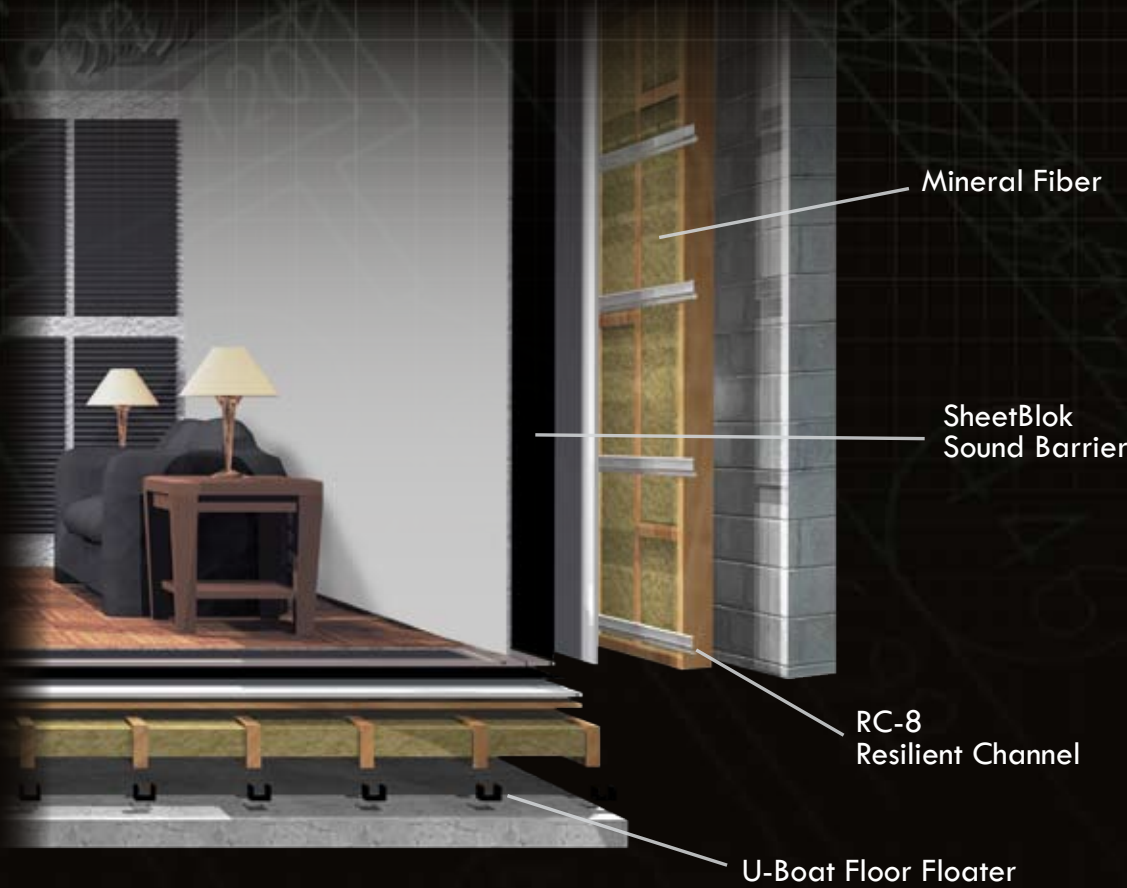

**Isolation Materials**

To achieve the ultimate acoustical environment, Auralex has developed a line of proprietary products designed to minimize sound transmission. These specialized sound-rated construction materials like SheetBlok Sound Barrier, Mineral Fiber Insulation, RC-8 Resilient Channel, U-Boat Floor Floaters, and StopGap Acoustical Sealant help to contain sound in your desired room. Auralex can help you or your contractor form a customized plan to meet your sound-proofing goals so you can enjoy your audio system around the clock.

# ELiTE™ Custom Fabric System

If you can imagine it, we can build it. Your theater can have the look and the sound you imagine with the ELiTE Custom Fabric System. Whether you're watching the big game or an Oscar nominated film, surround yourself in the theater of your dreams.

Hidden behind each wall of Auralex's ELiTE Custom Fabric System is a combination of absorption and diffusion treatment that is engineered specifically for your room. Auralex engineers will analyze your room's natural acoustics and develop a treatment plan to fit with the aesthetic concept. Through 2D sketches and 3D renderings, we will work with you or your interior designer to make your vision become reality.

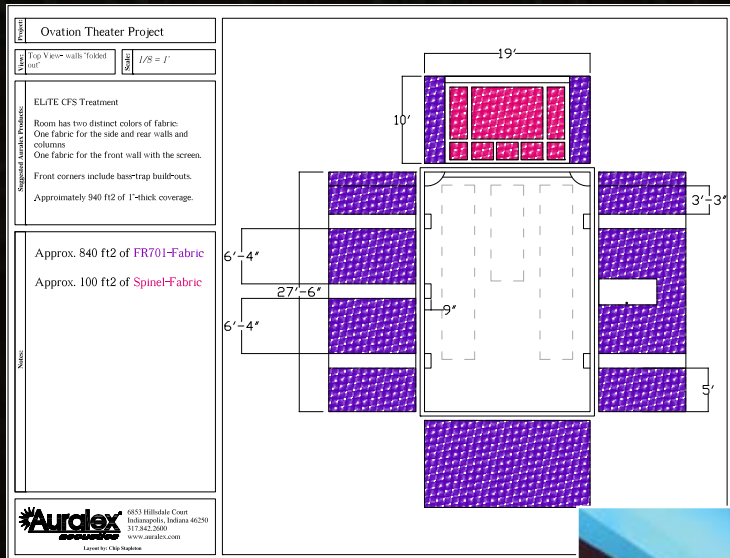

## Concept

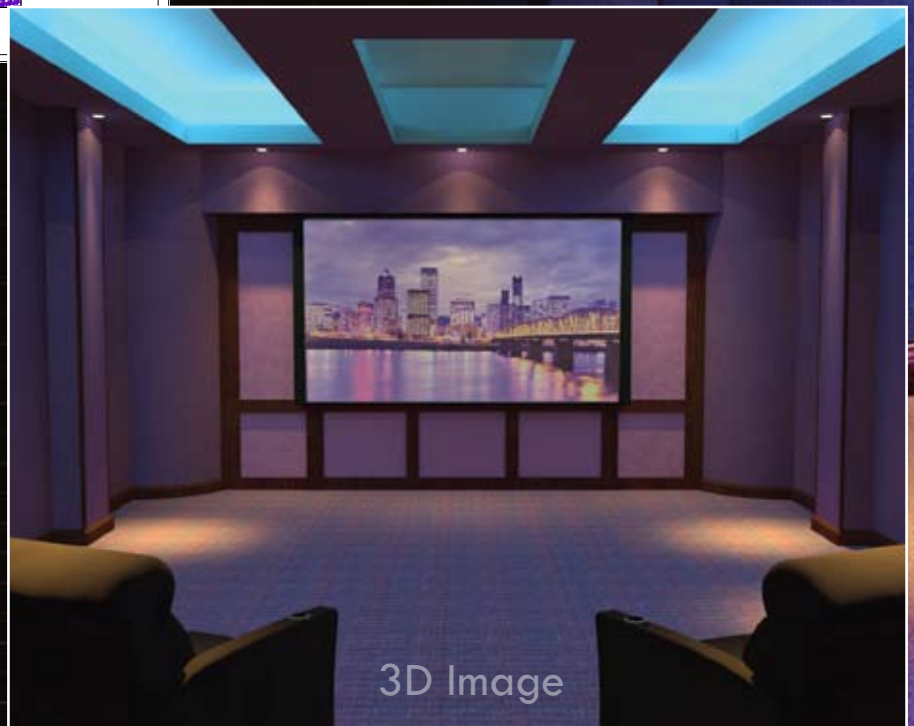

## Vision



Reality

# Custom Installation Options



## ELiTE Fiber-Optic Star Field

Add the element of imagination to your theater by creating a star field that is completely unique to your room. Auralex's ELiTE Fiber-Optic Star Field is built by hand and tailored to your wishes. The system incorporates randomly placed energy-efficient LED lighting into velour fabric for a realistic, breathtaking nighttime sky.

- Shooting stars
- Constellations
- 3D visual effects

## Prosceniums

Refine your look and your sound by customizing the most viewed wall in your theater, the proscenium. A proscenium can mask unsightly elements of your system while improving your room's listening environment.

- Conceal speakers
- Shadow-box a screen
- Hide equipment racks
- Add custom bass traps
- Motorized drapes



# ELiTE™ ProPanels

## ELiTE ProPanels

ELiTE ProPanels are fabric-covered absorption panels designed to keep the sound image crisp and clean, providing a more pleasing and accurate listening environment. Completely customizable, ELiTE ProPanels can be a cost-effective alternative to the ELiTE Custom Fabric System.

Create your own design with custom sizes and shapes as large as 4' x 12' or 5' x 10' with up to 4" of thickness. Choose from select edge styles and hundreds of fabric options to match any design scheme. Installation and removal are simple!



# SonoSuede™ Systems

## SonoSuede Systems

The Auralex SonoSuede Systems are cost-effective, complete do-it-yourself room treatment solutions. These synthetic suede panels provide sound control for any critical listening environment and are easy to install. Available in rectangular or trapezoidal shapes, the SonoSuede Panels look sharp and provide the acoustical performance you've come to expect from Auralex.



# SonicPrint™ Acoustical Panels

## SonicPrint Panels

A picture is worth 1000 words, but a SonicPrint panel is worth even more! With SonicPrint absorption panels, your wall hangings can help tell a story while simultaneously improving your listening environment.

Choose from our online collection by independent artists or submit your favorite landscape or family photo and let Auralex help you turn it into a functioning work of art!



**SonicPrint**<sup>™</sup>  
Artistic Acoustical Panels

ABCTV • AT&T • Apple Computer • Audio Technica • Barnes & Noble, New York City • Beyonce  
• Bose • CBS Sports • CBS Television's CSI • Castle Oak Productions (Titanic, Tremors, Wings,  
21 Jump Street, Jose Feliciano, Sergio Mendes) • CharlieUniformTango, Dallas (Cadillac,  
JC Penney, AT&T) • Cinema Video • Collateral Damage (Warner Bros./A. Schwarzenegger  
Film) • Crawford Post • David Schwartz (Northern Exposure, Ellen Degeneres, etc.) • Dick  
Ervasti (Voice of Sports on Fox & Tons More) • Digital Sound Works (Babylon 5, Frazier/  
Becker, NBC, ABC) • Don LaFontaine (voiceover god) • Dreamworks • EA Sports • ESPN  
• Extreme Makeover: Home Edition • Folded Space Technologie • Harpo Studios (Oprah  
Winfrey's Company) • Hitachi • JBL • Klipsch • Kodak • LucasArts Entertainment Co. • MPI  
Home Video (ABC News, Apple Records) • MUMFORD (A Lawrence Kasdan/Touchstone  
Film) • Macromedia • Make A Wish Foundation • Martin-Logan • Maury Povich Show  
• Microsoft • Mormon Church Television • MSNBC • NASA (Mission Control & Kennedy  
Space Center) • NBC Sports • NBC Television's "Chuck" • Nintendo • Not Just Jingles, New  
York City (NFL on Fox, ABC, Coke) • Pat Duke (Voice of McDonald's, Miller Brewing, Etc.) •  
Pioneer • Qualcomm • Rainbow America (Disney, Microsoft, Columbia Pictures) • Rockwell  
International • Sony • Star Trek Voyager Television Show • The Discovery Channel • The  
Family Channel • The Golf Channel • Time Warner Cable • Tom Lavin (Animaniacs, Pinky  
and the Brain) • 20th Century Fox • Universal Studios • Walt Disney Company • Warner

